

# 3-171SL Flat Rod with Brass Rollers SNAP-LINE

Tool-less installation, Brass rollers



## Product Notes:

- Flat rod with brass rollers
- Used with rod control unit - see Product System 3-150SL
- Rod Guide - see Product System 3-910
- Dual hook - see Product System 3-910 and 3-960SL

## Material:

- Flat rod: Steel, Zinc Plated
- Rollers: brass

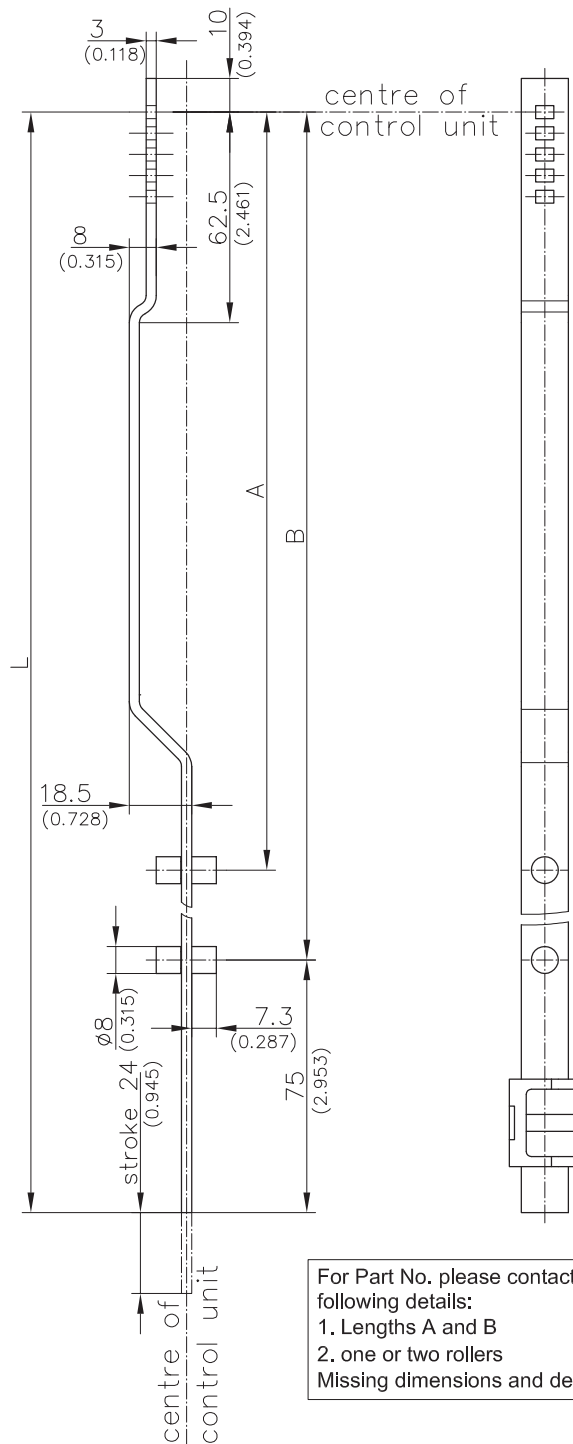
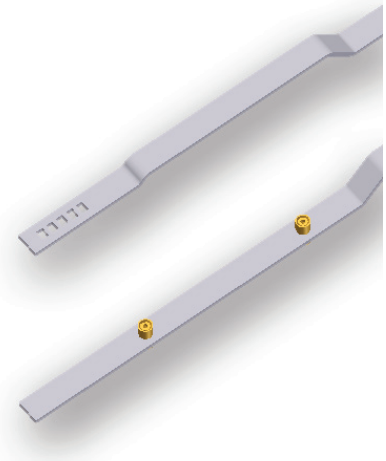

For Part No. please contact DIRAK. Please advise following details:  
 1. Lengths A and B  
 2. one or two rollers  
 Missing dimensions and details: see product system 3-170.

Flat rod with brass rollers

208-9837.00-L in mm