

1-181SL Adapter PA for Round Rods SNAP-LINE

Tool-less installation, Round rods, 3-point cam



Product Notes:

- Use with 3-point cam
- Rattle free
- Quick, tool-less installation on round rods (Ø8mm/0.315) with integrated one-way clamping ring. The clamping fingers spring onto the stud groove
- Adapter is not removeable
- This adapter should be used only with Quarter-Turns or Swinghandles that turn a maximum of 90 degrees
- Can be used with standard length round rods, without eyelets

NOTE: 14mm (0.551) difference in length when using adapter

- Screw-on - see Product System 1-181.01

Material:

- **Adapter:** PA, Black
- **Clamping Ring:** Spring Steel

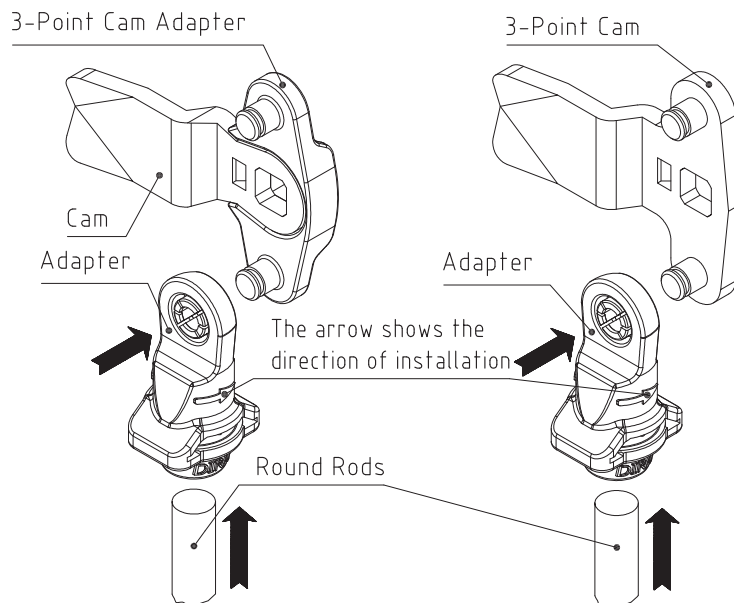
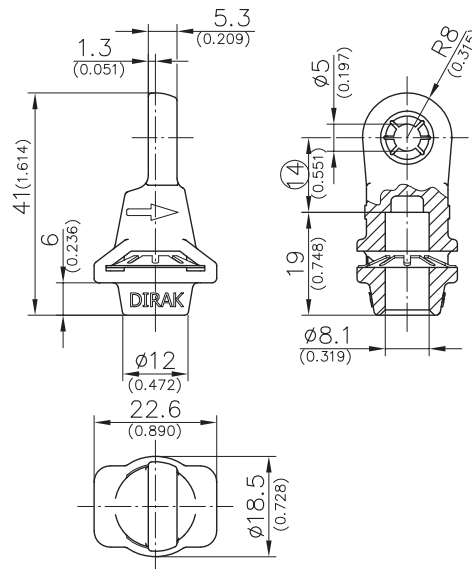

Adapter with clip-in installation

Adapter Zinc Die and stainless steel, screw-on

Part No.
200-9621

See Page

03.50