

# 3-145 Eject and Turn T-Handle FS/RS

Hand operable with or without key, IP65, Flat or round rods, WKII/RC security tested, Padlockable



## Product Notes:

- Retractable T-handle with 90° rotation for use with flat rod systems with Part No. 208-xxxx
- Minimal gap between handle and housing minimizes tampering
- Anti-vandalism device protects locking cylinder from being forcefully removed
- Retractable T-handle remains latched in two positions
- All locking devices or cylinders are located in a separate locking device sub-assembly. Can be used with eurocylinders, KABA-cylinders, key cylinders and inserts. Padlock option can be used with any locking method
- Locking sub-assembly can easily be installed or removed when open
- Can be installed inside or outside the sealed area
- RH and LH applications
- Complies with security standards WKII/RC, DIN 1630
- Water and dust tight according to IP65, DIN EN 60529
- Latch can be operated electrically with remote controlled servo-system - contact DIRAK for more information

## Material:

- **Dish, T-handle, cover, insert and spacer:** Zinc Die, Black or RAL 7032
- **Flat rod and rod stub:** Steel
- **Padlock eye:** Stainless Steel AISI 304
- **O-Ring:** NBR, Black

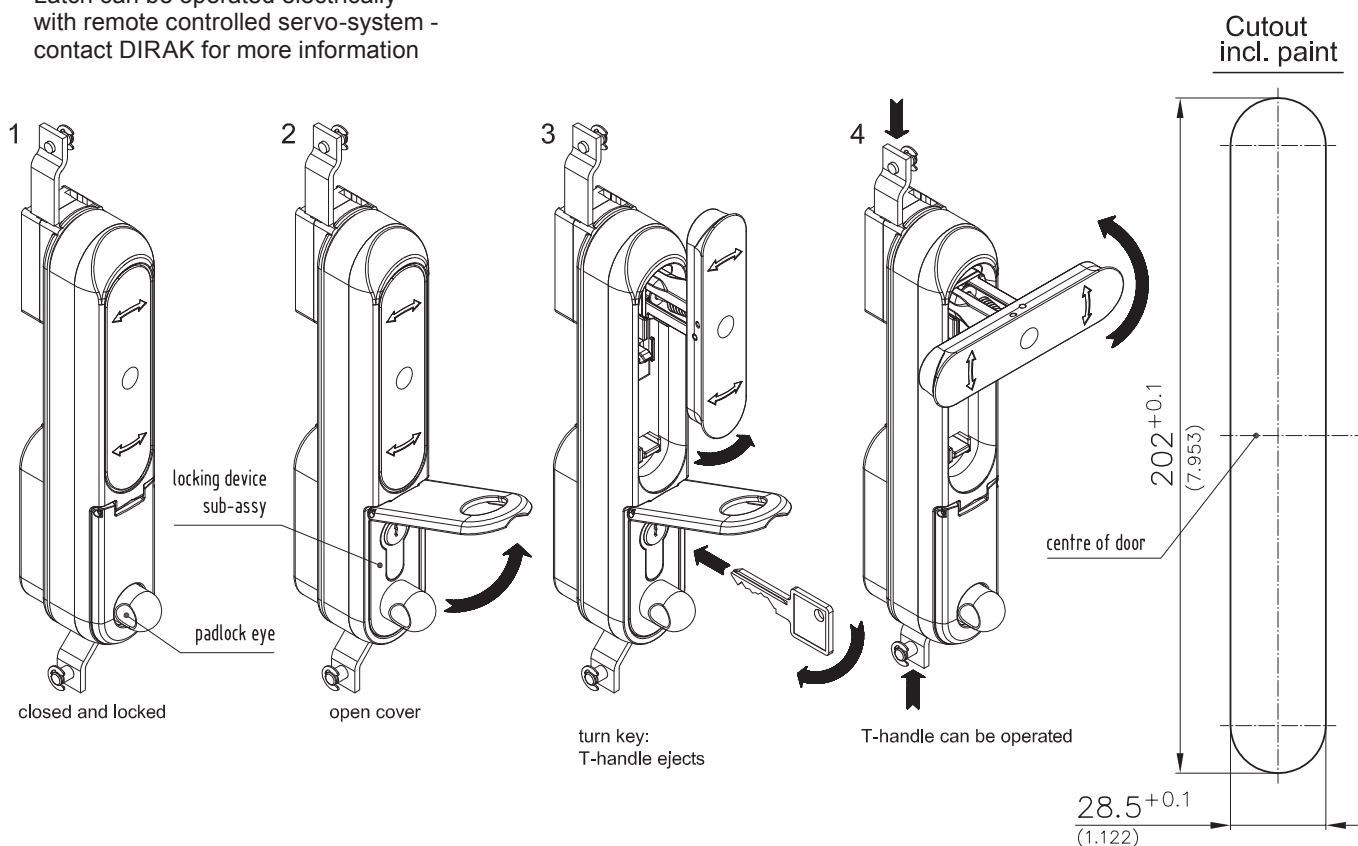

T-Handle with Insert for		Black Coated	See Page
a) Profile cylinder	without padlock eye	302-9001.00-60000	
b) Profile cylinder	with padlock eye	302-9001.00-30000	
c) KABA	without padlock eye	302-9001.00-50000	
d) KABA	with padlock eye	302-9001.00-20000	
RAL 7032 - Prices and delivery time on request.			
Rods on request.			
Profile cylinder only version A.			02.65

### 3-145 Eject and Turn T-Handle FS/RS

Hand operable with or without key, IP65, Flat or round rods, WKII/RC security tested, Padlockable

